

mifold[®]

Grab-and-Go[™] Booster Seat

Model Number: MF01-US

For Children:

at least 4 years of age
40 to 100 lbs. (18 to 45 kg)
40 to 57 inches (102 cm to 145 cm)

- This child restraint conforms to all applicable Federal Motor Vehicle Safety Standards for use in motor vehicles.
- This child restraint is NOT certified for use in aircraft.

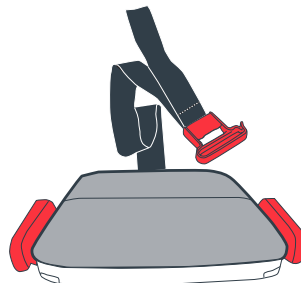
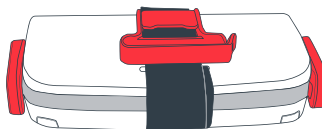

Table of Contents

Weight and Height Use Recommendations.....	2
mifold - Booster Seat Parts.....	3
Warnings.....	5
Proper Use Checklist.....	9
Selecting a Vehicle Seating Location.....	11
Vehicle Seat Belt Systems.....	16
Preparing for Use.....	19
Securing Child on Booster Seat.....	23
Removing Child.....	31
Removing Booster Seat.....	32
Re-Use After a Crash.....	34
Additional Information.....	36

Weight and Height Use Recommendations

- Child **MUST** be at least 4 years old.
- Child's weight **MUST** be between 40 and 100 lbs. (18 and 45 kg).
- Child's height **MUST** be between 40 and 57 inches (102 and 145 cm).



- Discontinue use when:
 - Top of child's ears are above top of vehicle seat back or headrest.
 - Child's weight exceeds 100 lbs. (45 kg).

mifold - Booster Seat Parts

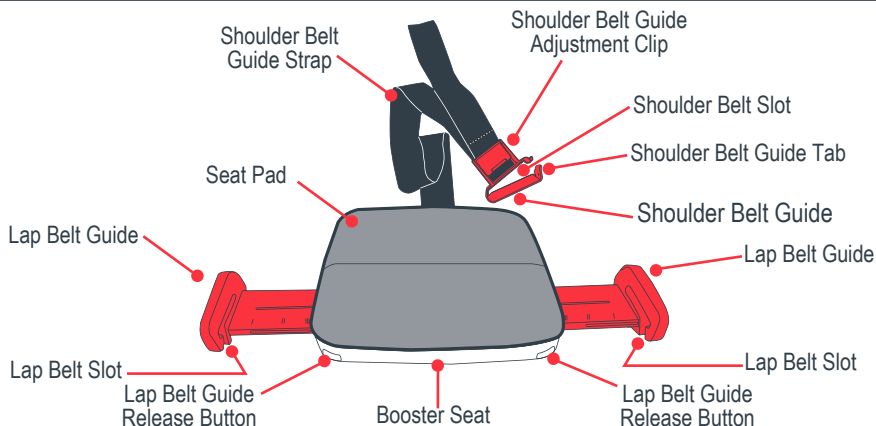



WARNING - DEATH or SERIOUS INJURY can occur

Failure to follow these instructions and car seat labels can result in child striking the vehicle's interior during a sudden stop or crash.

- Proper use is required:
 - Read and follow all instructions and information in this manual, product labels, and in the vehicle owner's manual for Booster Seat and vehicle seat belt use.
 - Improper use of the Booster Seat or vehicle seat belt can result in serious injury or death from a sudden stop or crash.
- Use **ONLY** with children who weigh between 40 and 100 lbs. (18 and 45 kg.) and whose height is between 40 and 57 inches (102 and 145 cm) and are at least 4 years old.
- Use only the vehicle's lap and shoulder belt system when restraining a child in this Booster Seat. Lap belt portion **MUST** be through both belt guides.
- Snugly adjust vehicle lap and shoulder belt around child according to vehicle owner's manual.
- Always properly position vehicle belts on child and snugly adjust vehicle belts around child.
 - Vehicle lap belt **MUST** be positioned low on hips, contacting thighs and not up on the abdomen.
 - Vehicle shoulder belt **MUST** be centered on child's shoulder (not touching neck and not off shoulder).
 - **NEVER** use shoulder belt loose, positioned under child's arm, or behind child's back.

5

6



WARNING - DEATH or SERIOUS INJURY can occur

- **NEVER** use Booster Seat with only a vehicle lap belt across front of child. Use of lap belt only can result in serious injury or death.
- **NEVER** use Booster Seat in a vehicle front seat location unless recommended in vehicle owner's manual.
- Discontinue use of Booster Seat when top of child's ears are above top of vehicle seat back or headrest. Severe head and neck injuries can result without proper head support.
- **NEVER** use this Booster Seat with vehicle's LATCH car seat attachment system.
- Secure Booster Seat even when not occupied. Unsecured items may injure other occupants in a crash.
- **DO NOT** use Booster Seat if it has been in a crash or is damaged, missing parts or the instruction manual is missing.
- Register child restraint with the manufacturer. See Registration section.
- **NEVER** leave child unattended.
- This Booster Seat is certified for use in motor vehicles. **DO NOT** use this Booster Seat in the home, on boats, on aircraft or other non-certified applications.
- Only use Booster Seat on forward-facing vehicle seats with child facing front of vehicle.
- Discontinue use after 7 years from date of manufacture printed on Shoulder Belt Guide.

7

8

Proper Use Checklist

- ✓ Booster Seat and child's back **MUST** make contact with vehicle seat back.
- ✓ Vehicle Lap and Shoulder Belt **MUST** be properly positioned on child.
 - Lap Belt low on hips, contacting thighs and not up on the abdomen.
 - Shoulder Belt centered on child's shoulder.
 - Lap and Shoulder Belt snugly adjusted around child.
- ✓ If using a seating position with a frontal airbag, adjust vehicle seat back, away from airbag, as far as possible according to vehicle owner's manual.



- ✓ Child **MUST** be sitting up, with back against vehicle seat back not slouching down under Vehicle Lap Belt.
- ✓ Top of child's ears are below top of vehicle seat back or vehicle headrest.

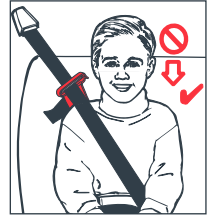

No car seat can guarantee protection from injury in every situation, but proper use helps reduce the risk of serious injury or death.

9

10

Selecting a Vehicle Seating Location



WARNING

DEATH or SERIOUS INJURY can OCCUR

- DO NOT use Booster Seat in a seating position with a frontal air bag unless recommended by the vehicle manufacturer.
- DO NOT use Booster Seat with a Vehicle Lap Belt **ONLY**.



- Refer to vehicle owner's manual for information on securing children and vehicle seat belt use.
- NOT all vehicle seat belts can be used with the Booster Seat. Read vehicle owner's manual on Booster Seat use and "Vehicle Seat Belt Systems" section in this manual.

Select a Seating Location To Use:

- Select a vehicle seating location that faces the front of the vehicle and has a Vehicle Lap and Shoulder Belt system.

11

12

Selecting a Vehicle Seating Location

Vehicle Seating Locations NOT To Use:

1. LATCH Anchorage System (Lower Anchorage and Tether for Children):

- Do not use the vehicle lower anchorages of the LATCH system with this Booster Car Seat.

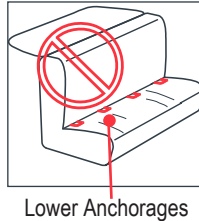

13

2. Side Facing and Rear Facing Seats:

- DO NOT use on side or rear-facing vehicle seats.

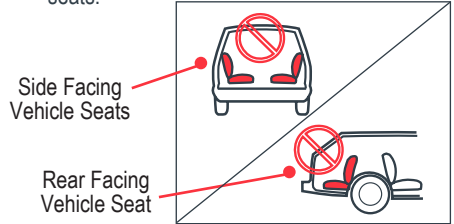

14

Select A Vehicle Seating Location

National Highway Traffic Safety Administration (NHTSA) alerts vehicle owners that according to accident statistics, children age 12 and under are safer when properly restrained in the rear seating positions rather than the front seating positions. For vehicles with air bags, refer to vehicle owner's manual for child restraint installation information.

DO NOT place rear-facing child seat on front seat with air bag. DEATH OR SERIOUS INJURY can occur. The back seat is the safest place for children 12 and under.



WARNING

NO coloque el asiento infantil para el automóvil orientado hacia atrás en el asiento delantero del vehículo que tenga una bolsa neumática de seguridad. El niño podría MORIR O SUFRIR LESIONES GRAVES. El asiento trasero es el lugar más seguro para los niños de 12 años o menores.

15

Vehicle Seat Belt Systems

- This Booster Seat MUST be used with a Vehicle Lap and Shoulder Belt system. DO NOT use the Vehicle Belt systems in this section.

1. Lap Belts ONLY Systems:

Vehicle Seating Locations With ONLY A Lap Belt:

- Do NOT use seating locations with Lap Belt ONLY.

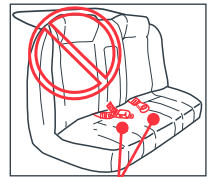

Lap Belt Only

16

Vehicle Seat Belt Systems

2. Passive Restraint Systems:

A. Motorized Shoulder Belts:

- Do not use seating locations with motorized shoulder belts.

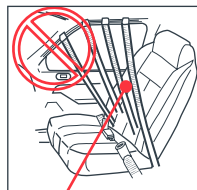

Motorized Shoulder Belt

B. Door Mounted Lap And Shoulder Belt:

- Do not use front seating locations where seat belts are mounted to the door.

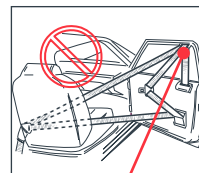

Belts Mounted To Door

3. Inflatable Seat Belt Systems:

- Do not use Booster Seat on a vehicle seating location with an inflatable seat belt.

17

18

Preparing for Use

WARNING DEATH or SERIOUS INJURY can occur

- Use only with the Vehicle's Lap and Shoulder Belt.
- DO NOT use with a Lap Belt only or lower anchorages of the LATCH system.
- Position and snugly adjust Lap Belt, then position and adjust Shoulder Belt.
 - Lap Belt MUST be low on hips, contacting thighs and not up on the abdomen.
 - Shoulder Belt must be centered over shoulder (NOT up on neck or off shoulder).
 - DO NOT use Shoulder Belt loose, positioned under child's arms, or behind child.

- Adjust the width of the Lap Belt Guides.

The Lap Belt Guides have four adjustment positions, one for storage and transport and three to adjust to child as they grow. Position numbers I, II and III on the Lap Belt Guide arms can be used to quickly position the Lap Belt Guides for repeat use.

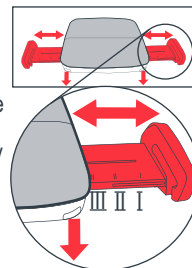

NOTE: The narrowest locked adjustment position is for storage and transportation only.

19

20

Preparing for Use

2. The Lap Belt Guides should be adjusted into the position nearest to, but not touching the sides of the child's thighs.

To adjust width of Lap Belt Guides:

- a. Pull out and hold Lap Belt Guide Adjustment Button ① and slide Lap Belt Guide out to the maximum position ②. Release Lap Belt Guide Adjustment Button.

Repeat on opposite side.

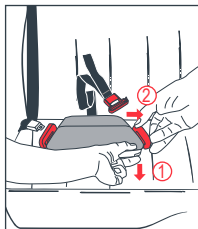

- b. Adjust to fit child.

1. Place Booster Seat with Lap Belt Guides extended on vehicle seat.
2. With child sitting on the Booster Seat, slide Belt Lap Guide into the position nearest to, but not touching child's thigh ③.
3. Pull out on Lap Belt Guide to check it is locked into position ④.
4. Repeat on opposite side.

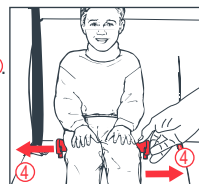
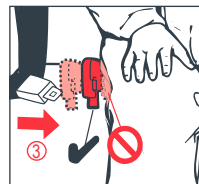

22

Securing Child on Booster Seat



WARNING

DEATH or SERIOUS INJURY can occur

- DO NOT use Booster Seat in a seating position that has a Vehicle Lap Belt ONLY.
- Vehicle Lap and Shoulder Belt MUST be snugly adjusted around child.
- Vehicle Lap Belt MUST be positioned low on hips, contacting thighs and not up on the abdomen.
- Vehicle Shoulder Belt MUST be over child's chest and centered on shoulder. DO NOT allow child to place Shoulder Belt under arm or behind back.
- NEVER use Booster Seat with only a Lap Belt across front of child. Use of Lap Belt ONLY can result in serious injury or death.

1. Unfold and place Booster Seat on vehicle seat in a seating location that has a Vehicle Lap and Shoulder Belt.
2. Adjust Lap Belt Guides into position for child. See "Preparation For Use" section.
3. Slide Booster Seat back on vehicle seat cushion so that the back of the Booster Seat makes contact with vehicle seat back cushion.

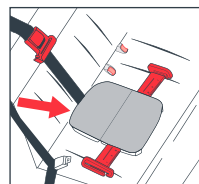
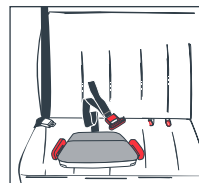

24

Securing Child on Booster Seat

For contoured vehicle seats, position back of Booster Seat on contour and in contact with vehicle seat back.

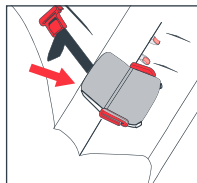

4. Seat child on the Booster Seat with child's rump and back in contact with the vehicle seat back cushion.

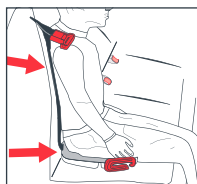

5. Secure child with the Vehicle Lap and Shoulder Belt.

- a. Slide Lap Belt portion of vehicle belt completely into the Lap Belt Guides ^① and ^② and buckle the vehicle seat belt.



NOTES:

- Vehicle Lap Belt **MUST** be through Lap Belt Guides on both sides of seat.
- DO NOT place shoulder belt through EITHER Lap Belt Guide.



25

26

Securing Child on Booster Seat

- b. Pull up on Vehicle Shoulder Belt to remove slack from lap portion of Vehicle Seat Belt and snugly adjust Lap Belt around child. Check that Vehicle Lap Belt is low on hips and contacting thighs.

- c. Place Shoulder Belt Guide Strap behind child's back and adjust the position of the Shoulder Belt Guide so Shoulder Belt Slot is at least 1 inch (25 mm) above top of child's shoulder.



To adjust position of the Shoulder Belt Guide:

- Pull out on Shoulder Belt Guide Adjustment Clip ^① to release Shoulder Belt Guide Strap, slide Shoulder Belt Guide into position ^② and then press down on the Shoulder Belt Guide Adjustment Clip to lock in place ^③.

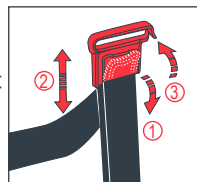

- d. Place Vehicle Shoulder Belt into Shoulder Belt Guide Slot.

- Pull out on Shoulder Belt Guide Tab ^④ on Shoulder Guide to open Shoulder Belt Slot.

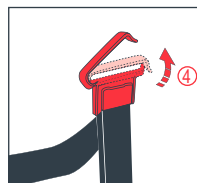

27

Securing Child on Booster Seat

- Slide Vehicle Shoulder Belt into Shoulder Belt Slot (5) then push down on top of Shoulder Belt Guide to snap Shoulder Belt Slot closed (6).

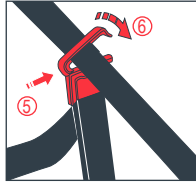

- e. Pull on Vehicle Shoulder Belt to snugly adjust Vehicle Lap and Shoulder Belt around child according to the vehicle owner's manual. Snugly adjust Lap Belt and then Shoulder Belt.
- f. Check that Vehicle Lap Belt is low on hips and contacting thighs and Vehicle Shoulder Belt is centered on child's shoulder.

WARNING DEATH or SERIOUS INJURY can occur

- Avoid potential abdominal injury from submarining under Vehicle Lap Belt. Child **MUST** sit with rump and back in contact with the vehicle seat back cushion and vehicle seat belt snugly adjusted.
- To avoid injuries from whiplash, top of child's ears **MUST** be below top of vehicle seat back or headrest.
- Discontinue use of Booster Seat when top of child's ears are above top of vehicle seat back or headrest.

29

30

Removing Child

To Remove Child:

- Unbuckle Vehicle Lap and Shoulder Belt.
- Slide lap portion of Vehicle Lap and Shoulder Belt out of Lap Belt Guide on buckle side.
- Move Vehicle Lap and Shoulder Belt off of child.
- Remove child from Booster Seat.

31

Removing Booster Seat

Transportation and storage of Booster Seat:

The mifold - Booster Seat folds into a very compact size for easy storage when not in use.

To store Booster Seat:

- Slide open Shoulder Belt Guide and remove Vehicle Shoulder Belt.
- Slide lap portion of Vehicle Lap and Shoulder Belt out of both Lap Belt Guides.
- Push both Lap Belt Guides into their storage position.
- Remove and fold mifold Booster Seat.
- Store mifold Booster Seat in a secure location such as the glove box, trunk, or storage area.

32

Removing Booster Seat

For transporting Booster Seat when not occupied:

When not occupied, it is recommended to fold and store the mifold in a secure location such as the glove box, trunk, or storage area. However, if it is left on the vehicle seat it **MUST** be secured with a vehicle belt as described below.

- Route lap portion of Vehicle Lap and Shoulder Belt through both Lap Belt Guides.
- Buckle Vehicle Lap and Shoulder Belt and snugly adjust the lap portion of the vehicle belt around Booster Seat.



WARNING

DEATH or SERIOUS INJURY can occur

- Secure this Booster Seat even when not occupied. An unsecured Booster Seat can injure other occupants in a crash.

33

Re-Use After a Crash



WARNING - DEATH or SERIOUS INJURY can occur

- DO NOT allow any use of this child restraint after a crash where a child was secured in the Booster Seat.
- Do not sell or allow others to use a child restraint that was occupied in a crash.
- This child restraint must be destroyed and replaced if it was occupied during a crash.

34

Re-Use After a Crash

The mifold Booster Seat is a unique design that absorbs some of the forces in a vehicle crash when occupied by a child. These crash forces can deform parts of the Booster Seat and result in damage that may not be detectable by a visual inspection. As a result, the Booster Seat **MUST** be replaced after any crash in which the Booster Seat was occupied.

For a crash in which the Booster Seat was stored and remained in place or was secured with the lap portion of the vehicle seat belt passing through both lap belt guides, and was unoccupied at the time of crash, the mifold may continue to be used.

35

Additional Information

Certification:

- **Motor Vehicle Use** - this child restraint meets or exceeds all applicable requirements of Federal Motor Vehicle Safety Standard 213 for use in motor vehicles.

This Booster Seat is for use in passenger cars, multi-purpose vehicles (vans and SUVs), trucks, and school buses that have Vehicle Lap and Shoulder Belt systems.

- **Aircraft Use - This Restraint is Not Certified for Use in Aircraft.** Aircraft seats do not provide a lap and shoulder belt system.



36

Additional Information

Care and Cleaning:

- Surface wash with a mild solution of soap and water. No Bleach. Remove soap by wiping with clean water after washing. Air Dry.

Instruction Manual Storage:

- Store instruction manual in storage compartment located in bottom of Booster Seat.

Replacement Parts:

- Product does not have any replaceable parts.
- For any issues or further information, contact mifold Customer Service at 1-800-437-6540 or by email at support@mifold.com.

Warranty:

- At Carfoldio, we make innovative, high quality products for children. We warrant this product to be free from defects in material and workmanship existing at the time of manufacture for a period of one year from the date of initial purchase (sales receipt is required for proof of purchase). If such a defect is discovered during the limited warranty period, we will, at our sole option, repair or replace your product at no cost to you.

This limited warranty does not cover claims resulting from misuse, failure to follow the instructions on installation, maintenance and use, abuse, alteration, involvement in an accident, and normal wear and tear.

37

38

Additional Information

Warranty (continued):

This limited warranty is exclusive and in lieu of any other warranty, written or oral, including but not limited to any express warranty of merchantability or fitness for a particular purpose. The duration of any implied warranties, including any implied warranty of merchantability or fitness for a particular purpose, is expressly limited to this limited warranty period.

Some states do not allow limitations on how long an implied warranty lasts; therefore, the above limitations and exclusions may not apply to you.

Warranty (continued):

The customer's exclusive remedy for breach of this limited warranty or of any implied warranty or of any other obligation arising by operation of law or otherwise shall be limited as specified herein to repair or replacement, at our sole option. In any event, responsibility for special, incidental and consequential damages is expressly excluded.

Some states do not allow an exclusion or limitation of special, incidental or consequential damages, therefore, that limitation or exclusion may not apply to you.

39

40

Additional Information

Warranty (continued):

This limited warranty gives you specific legal rights, and you may have other rights that vary from state to state.

For warranty service:

Please call 1-800-437-6540,
email support@mifold.com,
or write to: Carfoldio Ltd.
10685-B Hazelhurst Dr., #17695
Houston, TX 77043.

Registration and Recall:

- Child restraints could be recalled for safety reasons. You must register this restraint to be reached in a recall. Fill out the registration card attached to Booster Seat and mail today or send your name, address, e-mail address if available, and the restraint's model number and manufacturing date to:

Carfoldio Ltd.
10685-B Hazelhurst Dr., #17695
Houston, TX 77043

or call 1-800-437-6540

or log onto www.mifold.com/register

Model Number is on Shoulder Belt Guide Strap label.
Manufacturing Date is on Shoulder Belt Guide label.

41

42

Additional Information

NOTES

For recall information:

- Call the U.S. Government's Vehicle Safety Hotline at 1-888-327-4236 (TTY: 1-800-424-9153)
- Go to www.NHTSA.gov
- Call Carfoldio at 1-800-437-6540
- Log onto www.mifold.com
- Email: support@mifold.com

43

44

KEEP INSTRUCTIONS FOR FUTURE USE.

Store instruction manual in storage compartment on bottom of Booster Seat.

Instruction Manual

Carfoldio™ and mifold® are registered trademarks of Carfoldio Ltd.

Patent pending. This innovative product is protected by various patents and design registrations.



Instruction Manual Storage Compartment

Manufactured and distributed By: Carfoldio Ltd.
10685-B Hazelhurst Dr., #17695
Houston, TX 77043
www.mifold.com

Made in China
© 2015 Carfoldio Ltd.

1036 Rev D - US (EN) 16/06